

# INSTRUCTION SHEET

## Addition of Quickie Xtender

**(Please read and understand instructions before beginning installation)**

### Tools Required:

- Torx T-40 Wrench (6mm Allen Wrench on some models)
- Torx T-30 Wrench (5mm Allen Wrench on some models)
- 5mm Allen Wrench

- 30mm Open Ended, Socket, or Large Crescent Wrench
- 10mm Open Ended, Socket or Crescent Wrench
- Torque Wrench capable of delivering at least 144 in-lb Torque.

**Note:** BEFORE IMPLEMENTING THE STEPS BELOW - Read the Quickie Xtender User Instruction Manual to ensure thorough understanding of the characteristics, benefits and limitations of your wheelchair after converting to power assist.

**Note:** Quickie GT rear seat heights are limited to 18.5" to 20.5" (in 1/2" increments) when using the Quickie Xtender. The CG location can only be set to the 1" position.

### Removal of Standard Axle Plate Assembly (See Fig. 1)

- 1) Remove M8 Cap Screws (item 1), M6 Cap Screws (item 3), and M6 Lockwashers (item 2) from both sides of chair, leaving Axle Plate Clamps (item 4) and Axle Plate Sleeves (item 4A) on seat tube. Remove axle assembly (item 5) from chair and set aside along with all removed fasteners.

### Installation of Xtender Axle Plate Assembly (See Fig. 2 & 3)

- 2) Using new fasteners (items 1, 2 & 3) attach Axle Plate Mount (item 16) to Axle Plate Clamp (item 4) as shown, matching the round edge of the Mount with the radius on the inside of the Clamp. First tighten the M6 Cap Screws (item 3) to 144 in-lb. Next, tighten the M8 Cap Screws (item 1) finger tight. Repeat for opposite side of chair.
- 3) Attach Axle Plate (item 13) to Axle Plate Mount (item 16) using M8 x 35 Button Head Screws (item 17) as shown and securely tighten Nuts (item 15). Repeat for opposite side of chair.
- 4) As shown in Fig. 3, the required rear seat height determines Axle Bracket (item 14) mounting location onto Axle Plates (item 13). Attach using M6 x 35 Cap Screws (item 23) with M6 Washers (item 12) and M6 Locknuts (item 11) as shown. Repeat for other side of chair. If Anti-Tips (item 20) are to be installed, attach the Anti-Tip Receivers (item 19) to the rear set of Cap Screws (item 23) beneath the Locknuts as shown. Of the 3 available holes to use in the Anti-Tip Receiver to mount the Receiver, use the middle and bottom slots to mount as shown. Securely tighten all M6 Nuts (item 23).
- 5) Install Strut Tube (item 8) between the Axle Brackets (item 14) as shown, using M12 x 35 Button Head Screws (item 22) with M12 Lockwashers (item 21). Securely tighten screws on both sides of chair.
- 6) Slide the Axle Plate Clamps (item 4) along the wheelchair's seat tube to the 1" CG position (most rearward position, butted against the rear strut tube collars). Tighten M8 Cap Screws (item 1) on both Clamps to 144 in-lbs.

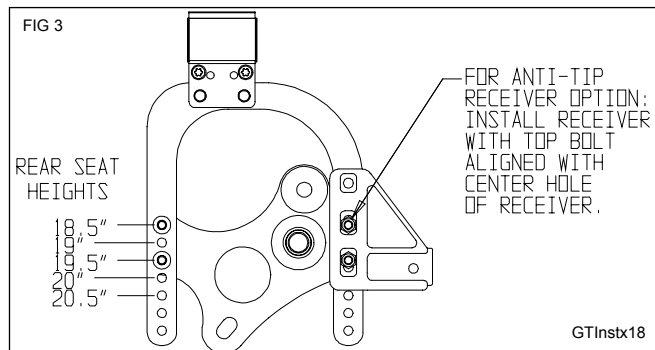
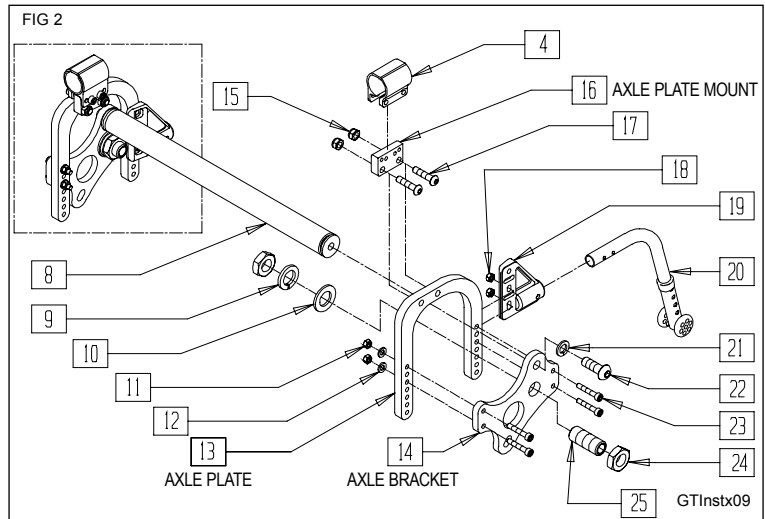
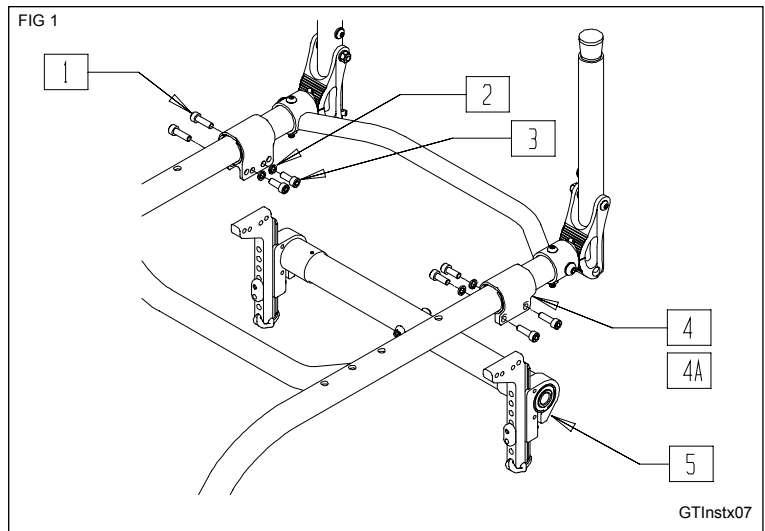

**FOR DEALER USE** Installed by: \_\_\_\_\_ Serial #: \_\_\_\_\_ Date: \_\_\_\_\_ (retain as record of installation)

## Installation of Axle Sleeve (See Fig. 4, 5 & 6)

Note: Referring to Fig. 4, the semi-circular Axle Handle is the quick release actuation lever used to securely install the Xtender wheels onto the wheelchair.

To remove the wheel assemblies from the wheelchair - rotate the Axle Handle away from the wheel (to the unlocked position) and pull the wheel away from the chair.

To install the wheel assemblies onto the wheelchair - keep the Axle Handle rotated to the unlocked position, slide the wheel Axle (item 7) completely into the Axle Sleeve (item 25), and rotate the Axle Handle flush to the wheel (to the locked position)

7) Thread one M20 Hex Nut (item 24) onto an Axle Sleeve (item 25) until the face of the Nut is flush with end of the Sleeve. Slide this assembly, with the nut located closest to the wheel, completely onto the left wheel Xtender Axle (item 6) (left wheel is not equipped with a battery tray). Ensure that Axle detent balls securely engage the Axle Sleeve. Slide the left wheel/Sleeve assembly into the left Axle Bracket (item 14), engaging the Xtender's Torque Pin (item 7) into the oval slotted Torque Pin Receiver on the Axle Bracket. The base of the Torque Pin should be completely flush with the face of the Axle Bracket. (See fig 6)

8) Reach between the Axle Bracket (item 14) and Xtender wheel and rotate M20 Hex Nut (item 24) until it becomes flush on the face of the Axle Bracket (item 14). Install M20 Flat Washer (item 10), M20 Lockwasher (item 9), and M20 Hex Nut (item 24) onto the backside of Axle Bracket as shown. Securely tighten M20 Hex Nut from the side with the washers. Repeat steps 7 and 8 for right side of chair.

### Final Assembly

- 9) Install the Anti-tips (item 20) into the Receivers (item 19).
- 10) Plug the cable-fitting end from the right-hand Xtender unit, aligning the painted marks. NOTE: It may be necessary to remove the water-resistant cover on the left-hand Xtender to access the receptacle.
- 11) Install the fully charged battery into the battery holder, with the battery release button oriented towards the front of the chair.

**WARNING!** Changing any components or settings of the rear axle assembly will change Stability Characteristics. Always use Anti-Tips or an attendant behind the chair until the rider becomes accustomed to the change.

