



# VOYAGE IV POLE AND O2 HOLDER



Please read these instructions carefully before beginning the installation. Failure to understand and follow installation instructions may result in injury to installer and/or end user and may void the warranty. If you have any questions call Sunrise Medical Technical support at 800-333-4000

### Parts in this kit:

- |                                 |                                     |
|---------------------------------|-------------------------------------|
| 1. Clamp assembly with hardware | 3. IV Hook with hardware            |
| 2. IV Pole                      | 4. O2 Holder assembly with hardware |

### Tools needed:

- a. 4mm hex key
- b. 5/64" hex key

## A. ATTACH THE O2 HOLDER TO THE VOYAGE FRAME 1 2

**NOTE-** For IV only, you will use the O2 holder tube without the ring set shown in the O2 holder assembly (4)

1. Using a 4mm hex key, locate the first half of the Clamp assembly (1) and attach it directly to the frame just under the Latch assembly (see clamp location in figure 2). You can choose to set up the clamp on either the Right or left side of your device and face it forward or rearward.
2. Attach the O2 holder tube (4) to the clamp assembly (1) by tightening the screw with a 4mm hex key

## B. INSTALL THE IV POLE ASSEMBLY (IF APPLICABLE) 1 2

1. Pre-assemble the IV hook.
  - a. Insert the IV Hook (3), through the upper tube connector(5) and collar. Tighten the collar set screws using a 5/64" hex key.
  - b. Attach the IV hook and upper tube connector to the long end of the IV pole(2) by hand tightening the upper tube connector(5)
2. Attach the IV pole to the O2 holder.
  - a. Insert the lower tube connector(6) over the O2 holder(4).
  - b. Insert the short end of the IV pole(2) through the O2 holder and lower tube connector(6). Hand-tighten the connector.

## C. CHECKOUT

1. Verify that all hardware has been installed and is tight.
2. Make sure the IV Pole/O2 Holder assembly has been installed correctly by adding the IV and/or O2 tank and checking for strength and stability of the assembly. If it moves or leans, remove components and check the location and tightness of the clamps.
3. Before use, make sure that tubes and hoses are secured so as not to interfere with any moving parts.
4. Once every 3 months, tighten all screws, and clean the unit by removing the components and wiping them down with a damp cloth.

### DEALER/TECHNICIAN WARNING



Attention dealers and qualified technicians, do not operate or service the device without first reading the owners manual. If you do not understand the instructions and warnings in the owners manual please contact the Quickie Technical Service Department before operating and/or servicing the Quickie wheelchair. Failure to do so may result in damage and/or injury.

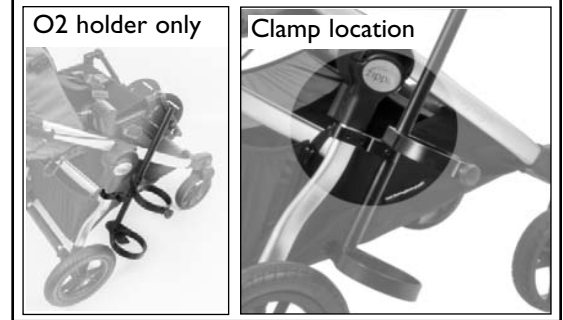
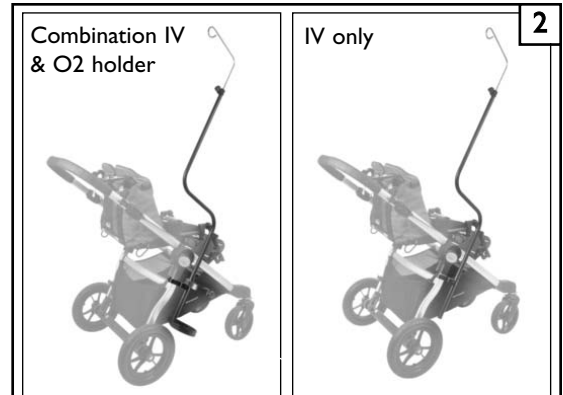
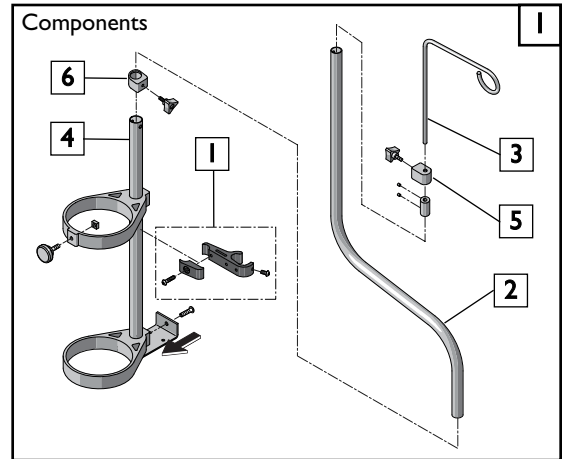

Sunrise Medical • 2842 Business Park Ave. • Fresno, CA 93727 • USA  
In Canada (800) 263-3390



Customer Service: 800.333.4000  
www.SunriseMedical.com

©2013 Sunrise Medical (US) LLC  
9.13 IS00133 Rev.A