



POWER CENTER MOUNT ACTUATOR KIT INSTALLATION INSTRUCTIONS



Please read these instructions carefully before beginning the installation. Failure to understand and follow installation instructions may result in injury to installer and/or end user and may void the warranty. For more information on components, or if you have any questions, call Sunrise Medical Technical support at 800-333-4000 or go to www.sunrisemedical.com.

- Parts for installing the new Actuator**
- A. 1x Actuator (Elevate) (Articulate)
 - B. 2x Mount screw, IGUS Bushing
 - C. 4x or 2x Bushing
 - D. 1x Hex screw/washer (Articulate)
 - E. 2x C-clips (Elevate)
 - F. 1x Pivot Pin (Elevate)

- Tools needed:**
- 1. 3,4,5mm hex key
 - 2. 14mm wrench,
 - 3. Flathead screwdriver
 - 4. Needle nosed pliers.

This instruction will take you thru the step by step process of installing a new actuator into your QM-7 or Pulse base.

IMPORTANT! Be sure that the chair is on a level surface. Make sure the Power Center Mount is as close to 90° as possible (Fig. 2) and fully retracted in the home position. Be sure the power is turned off and/or batteries disconnected before working on Electrical components.

A. REMOVING THE POWER CENTER MOUNT 2 10

I. Remove the Power Center Mount (PCM) assembly from the power base.

- a. Remove the cushion from the base.
- b. If the calfpads are in the way, loosen the calfpad brackets using a 5mm hex key and slide them up or down the rail so they don't interfere with the installation.
- b. Using a flathead screwdriver, lift tab(G) to unplug the Actuator(s).
- c. Using a 5mm hex key, remove the screws(H) holding the (PCM) to the Seat Pan, and the Fabric Guard (P), and set aside for re-assembly.
- d. Remove the Power Center Mount assembly from the chair.

2. Access to the actuator

- a. Using a 4mm Hex key, remove the hardware(I) and the shroud.
- b. Use a 5mm hex key remove the foot plate mount screws(J).
- c. Remove the footplates.

B. REMOVE ACTUATOR(S) FROM RAIL GUIDES 3 4 5 6

NOTE–Be careful not to lose sliding hardware when removing endcaps.

I. Access to the actuator

- a. Using a 14mm open end wrench, remove the large securing bolt at the bottom of the actuator(K).
- b. Use a 3mm hex key remove the screws that attach the rail endcaps(L).
- c. Remove the endcaps. Set all hardware aside for re-assembly.
- d. Slide the rail assembly(M)out of the bearing rails(N).

C. DISASSEMBLE ACTUATOR(S) FOR REPLACEMENT 1 2

I. Detach Elevate actuator from Articulating actuator

- a. Using a 3mm hex key, remove the hardware(B) securing the actuator to the Seat pan mounting bracket(O)(Standard or ASAP seating)
- b. Using a pair of needle-nosed pliers, remove the C-clips(E)from the shaft or pivot pin(F).
- c. Separate the Elevate actuator from the Articulate actuator, and push out the IGUS bushings(C) so they can be replaced.

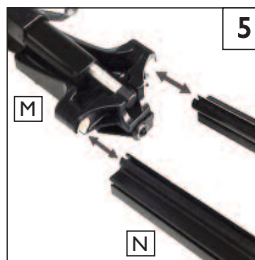
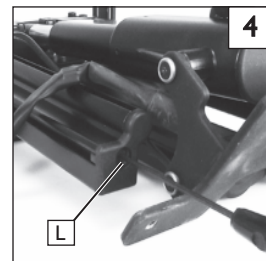
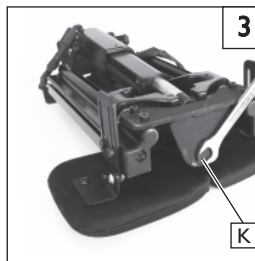
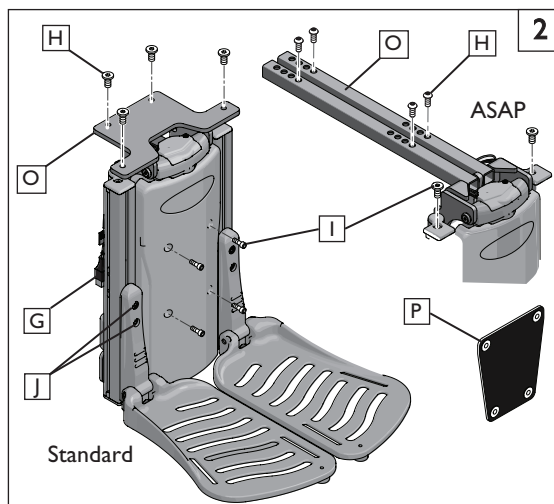
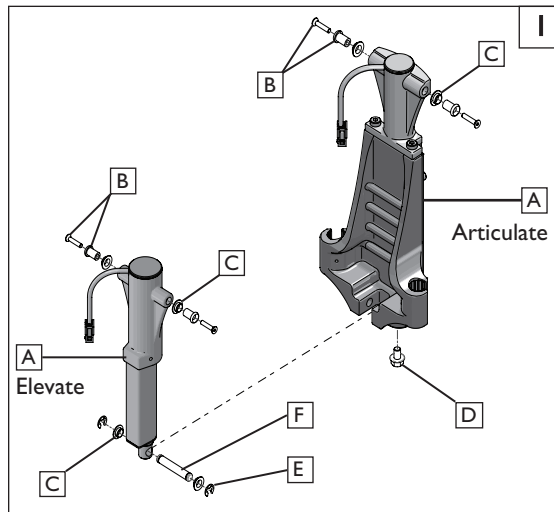

D. RE-ASSEMBLY OF THE NEW ACTUATOR(S) 7

1. Install both sets of bushings(A) into the Bracket(D). Install bushings (B) into the Articulate actuator.
2. Install Elevate actuator into the Articulate actuator. Insert the pin as shown in (Fig. 1,7). Use needle-nosed pliers to attach both C-clips(C).
3. Using a 3mm hex key, attach the the actuators to the mounting bracket(D) using hardware shown in (Fig.1)

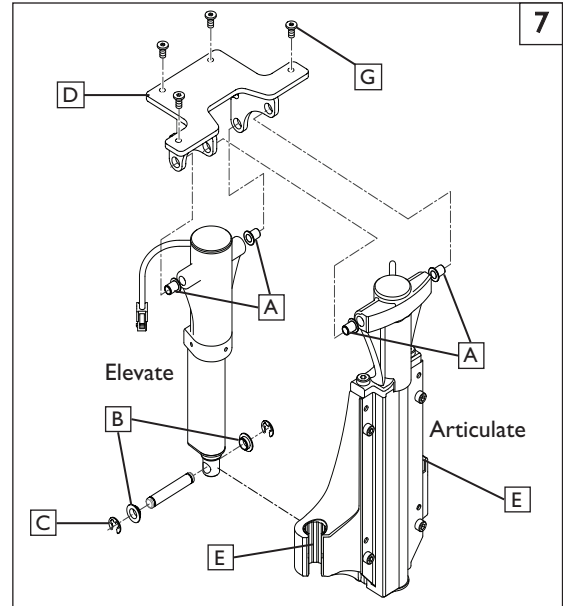

E. RE-ASSEMBLE ACTUATOR(S) AND RAIL GUIDES 8 9

1. Carefully and evenly insert the rail thru the actuator guides(E), Do not force the rails thru the guides, or the guide strips might be damaged.
2. Install Elevate actuator into the Articulate actuator as shown in (Fig. 1) Use needle-nosed pliers to attach both C-clips(C).
3. Using a 3mm hex key, attach the the actuators to the mounting bracket(D) using hardware shown in (Fig.1)
4. Using the 14mm wrench, thread the securing bolt(F) and tighten to a torque of (24 in-lbs)

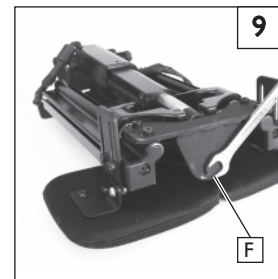

F. COVER, FOOTPLATES, AND CALFPADS 10

1. Using a 5mm hex key, attach the actuator assembly and bracket(D) to the seat pan, and tighten the screws (G) to (15 in-lbs)
2. Use a 4mm hex key to attach the cover to to the articulate actuator.
3. Use a 5mm hex key to attach the footplates. Tighten to (10 in-lbs)
4. Use a 5mm hex key, to attach the calypad brackets(H) to the rail guides and adjust.
5. Finally, re-connect batteries if needed, and plug in the actuators.

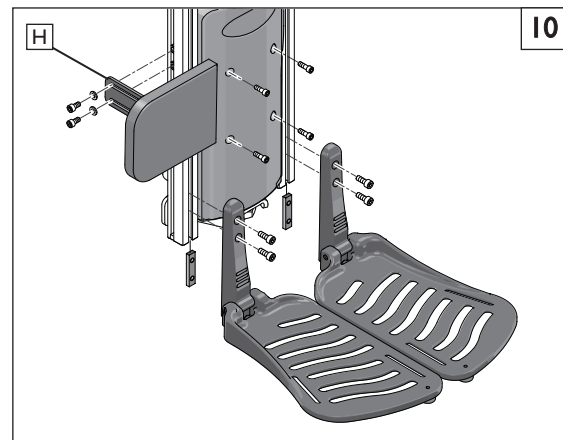

G. CHECKOUT

- I. **Double-check Orientation and Torque on all Hardware.**
 - a. Check that the actuator hardware, and seat pan bracket have been fully installed and adjusted to original specifications for the user.
 - b. Using a torque wrench and socket wrench to check all hardware for correct torque and tightness.

DEALER/TECHNICIAN WARNING



Attention dealers and qualified technicians, do not operate or service this device without first reading the owners manual. If you do not understand the instructions and warnings in the owners manual please contact the Sunrise Medical Technical Service Department before operating and/or servicing the Quickie device. Failure to do so may result in damage and/or injury.

Sunrise Medical • 2842 Business Park Ave. • Fresno, CA 93727 • USA
In Canada (800) 263-3390



Customer Service: 800.333.4000
www.SunriseMedical.com

©2015 Sunrise Medical (US) LLC
11.15 MK-100252 Rev.A