



WC-19 TRANSIT INSTALLATION QUICKIE 5^R



Please read these instructions carefully before beginning the installation. Failure to understand and follow installation instructions may result in injury to installer and/or end user and may void the warranty. If you have any questions call Sunrise Medical Technical support at 800-333-4000

1. Parts included in the Transit Kit:

- | | |
|-------------------------------|---|
| a. 2x 50mm Button Head (rear) | e. 2x Rear Transit bracket (Left and Right) |
| b. 2x 45mm Button Head (rear) | f. 4x nylon washer (Front) |
| c. 2x M6 flat washer (rear) | g. 4x M6 Socket Head (Front) |
| d. 8x M6 Nylock (front/rear) | h. 2x Front Transit brackets |

2. Tools needed:

- 4mm Hex key
- 5mm Hex Key
- 10mm open end wrench
- Needle-nose pliers

A. REAR TRANSIT BRACKET INSTALLATION

1. Remove Backrest and Backrest Bracket 1

- Remove the wheels to gain access to the screws (A) holding the back bracket and back post to the Chair frame. (B)
- Using a 10mm wrench, and a 5mm Hex Key, remove and save the Backrest bracket screw washer, and nut (C) for reassembly. Remove the backrest and brackets. Repeat this process for the opposite side of the chair.
- Using a pair of needle-nose pliers, remove the C-clip (D) and set screws in the housing (E) Detach Lanyard (F) and hardware from the backrest bracket. Save the backrest hardware for reinstallation.

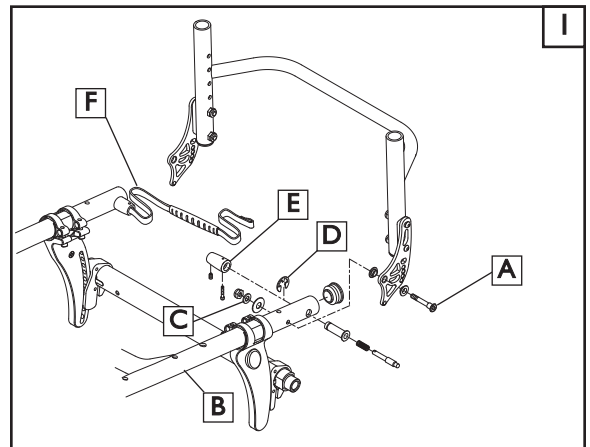

2. Install the rear Transit Brackets 2

- Using a 10mm wrench and a 4mm Hex Key, remove and **discard** the rearmost seat rail screw, nut, plastic saddle, and Washer (G) Repeat this process for the opposite side of the chair.
- Slide the Rear Transit bracket (H) onto the rear frame, and line up the thru holes. (left side Transit Bracket shown).
- Locate the longer 50mm button head screw, (I) M6 washer, and Nylock nut. Using the 10mm wrench and 4mm Hex Key, reassemble and snug (do not tighten) the hardware thru the rear frame.
- Locate the 45mm button head screw (J) washer, and nut. Using a 10mm wrench and 4mm Hex Key reassemble and snug (do not tighten) the hardware thru the rear frame.
- Repeat the process in steps (c and d) for the other side of the chair.
- Tighten all 4 button head screws holding the transit brackets to the frame, torque to 144 in/lb.

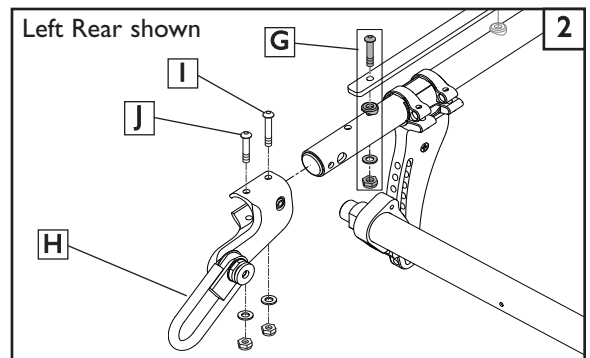

3. Finish the Rear installation 3

- Reinstall the Backrest Pivot Release pins (K), and attach the lanyard (L).
- Reinstall the Backrest and Backrest Brackets (M) reversing the order of the instructions shown in Step 1.
- Insure that there is no interference between the new Transit bracket and Lanyard and that both pivot pins can be fully engaged before use.
- Finish by tightening the Backrest bracket Cap screw (N) to a torque of 144 in/lb.

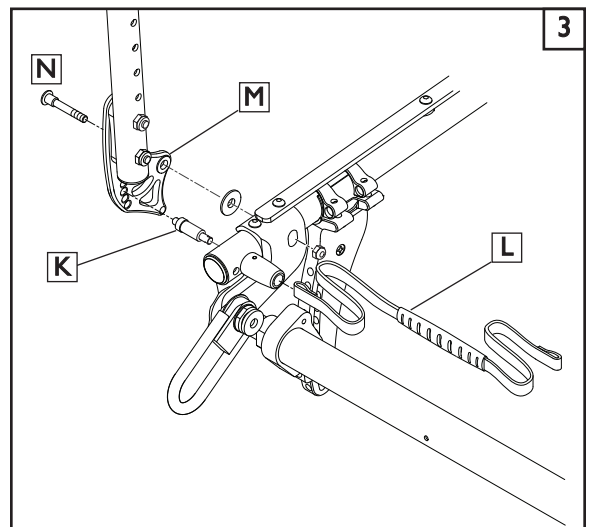

- 4. NOTE: for Transit Hardware included with this Kit** 4
- DO NOT use the hardware shown in figure 4 unless you intend to install a WC-19 approved Lap Belt (A). The washers and button head screws (B) include a patch that is intended to be permanent once installed.

B. FRONT TRANSIT BRACKET INSTALLATION

- I. Assemble and Place the Front Transit Bracket** 5 6
- Assemble the front transit bracket by placing the loop half of the bracket on the frame location (C) and interlocking with the clamp half of the transit bracket.
 - Locate the M5 socket head screws (D) and round nut (E). Using a 5mm hex key, thread the screws through the transit bracket and into the round nut with the bracket on the frame as shown in (Figure 5).
 - Make sure the transit hooks are aligned and set at the angle specified (Fig 6)
 - Finish by tightening the M5 socket head screws (F) to a maximum torque of 30 in-lb.



C. CHECKOUT

- I. Double-check torque on all hardware and Transit brackets**
- Using a torque wrench with a 4mm and 5mm Hex drive, check front and rear Cap screws for correct torque.
 - Using the Lanyard, and wiggling the back, check to make sure that the Rear Pivot Pins engage and disengage easily, they should “click” into place when back is in the upright riding position.
 - Place Transit stickers in the areas noted in (Fig. 7 and Fig. 8)**
 - If you have any questions regarding WC-19 Transit requirements, please refer to the WC-19 Transit supplement that is included with this kit.

DEALER/TECHNICIAN WARNING



WARNING

Attention dealers and qualified technicians, do not operate or service this wheelchair without first reading the owners manual. If you do not understand the instructions and warnings in the owners manual please contact the Quickie Technical Service Department before operating and/or servicing the Quickie wheelchair. Failure to do so may result in damage and/or injury.

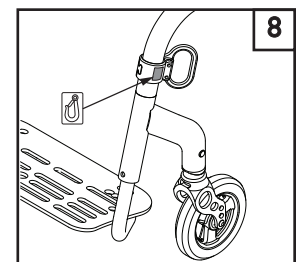
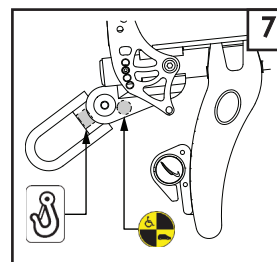
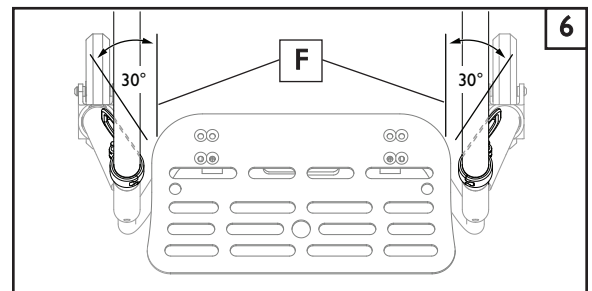
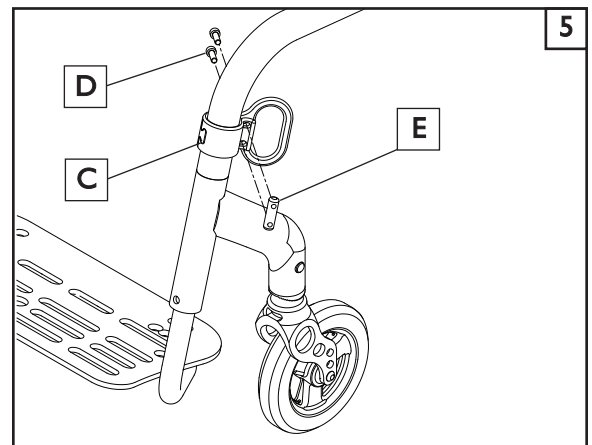
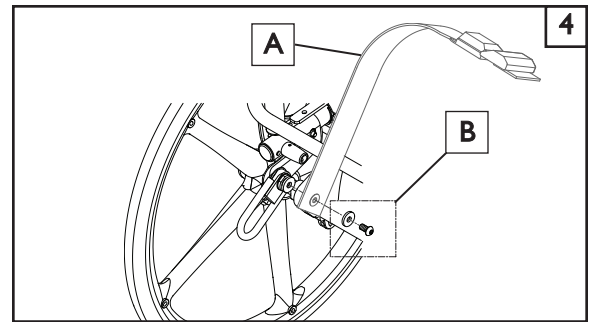

Sunrise Medical • 2842 Business Park Ave. • Fresno, CA 93727 • USA
In Canada (800) 263-3390