



QUICKIE 2 LITE TRANSIT INSTALLATION (WC-19)



Please read these instructions carefully before beginning the installation. Failure to understand and follow installation instructions may result in injury to installer and/or end user and may void the warranty. For more information on WC-19 Transit components, or if you have any questions, call Sunrise Medical Technical support at 800-333-4000 or go to www.sunrisemedical.com.

Parts included in this Transit Kit:

- | | |
|----------------------------------|-----------------------------------------------------------------|
| 1. 2x M8 1.25 x 14(rear) | 6. 2x Pelvic Belt Hardware (rear) |
| 2. 3x Back release saddle (rear) | 7. 2x Front Transit Bracket
(4 pieces: 2x Loop and 2x Clamp) |
| 3. 12x 1/4 AN flat washer (rear) | 8. 4x SHCS 1/4-28 x 1/2 (front) |
| 4. 6x Nylock nut 1/4-28 (rear) | 9. 4x M5 Socket Head Screw (front) |
| 5. 2x Rear Transit bracket | 10. 2x Front Transit location decals. |

Tools needed:

- 5mm hex key
- 5/32" hex key
- 3/6" hex key
- 7/16" open end wrench
- Torque wrench and hex bits

A. REAR TRANSIT BRACKET INSTALL

Works with serial numbers after: Q2L-152965.

I. Pre-installation: I

- Place your Q2 Lite Wheelchair on a Table or Flat work surface for best installation results.
- Remove the wheels, armrests, and any other obstruction to gain access to the frame holes (A) that will secure the Rear Transit Bracket(B).
- Using a 7/16" wrench and 5mm hex key reinsert the Rear support bracket and hardware as shown in (figure 1).

2. Install the Rear Transit Brackets 2

- Assemble the brackets and hardware for both sides of the chair as shown in figure 2.
- DO NOT use the Button head screw (C) unless you intend to install a WC-19 approved Lap Belt.
- If you choose to install a Pelvic Belt, mount the belt between Screw/washer (C)(E) and pivot (D).
- The button head screw(C) includes a patch that is intended to be permanent once installed.
- Torque all hardware to 144 in-lb.

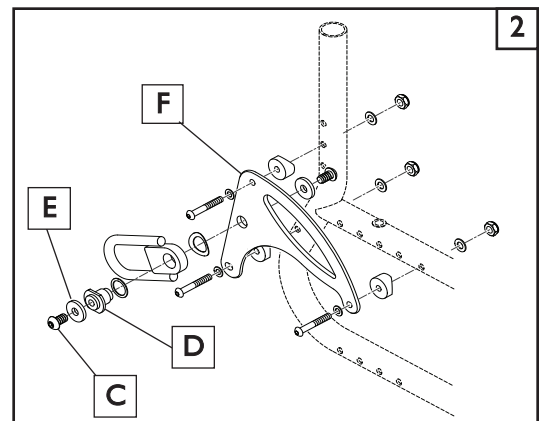
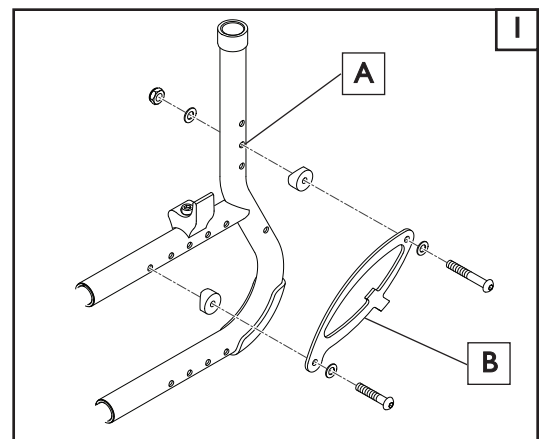

B. FRONT TRANSIT BRACKET INSTALLATION

I. Assemble and Place the Front Transit Bracket 3 4 5

- Assemble the brackets and hardware for both sides of the chair as shown in figure 3.
- For an easy installation, Start by placing the smaller clamp half(G) on the frame tube in the location shown. Attach the Loop half of the Transit Bracket(H) by holding the two pieces in place and loosely threading the screws thru both pieces.
- Repeat this process for the other side of the wheelchair.

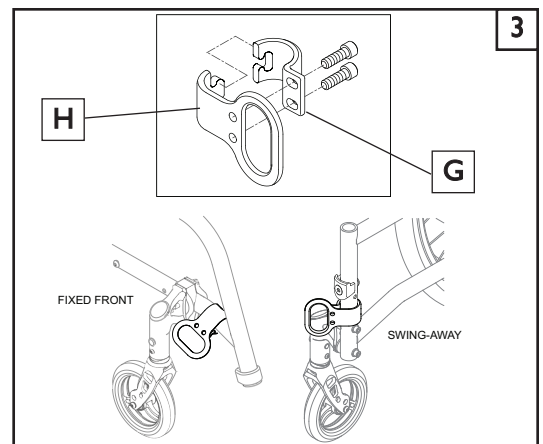

2. Orientation of Transit Brackets for a Fixed Front Setup.

4 5

- After loosely attaching the Transit loop(A) to the lower front frame be sure to rotate the assembly to the outside of the chair.
- Rotate the Transit bracket loop to a 30° angle (as shown) and hand tighten the screws(B).
- Using a 3/16" hex key, tighten and then torque the screws(B) to 120 in-lb.

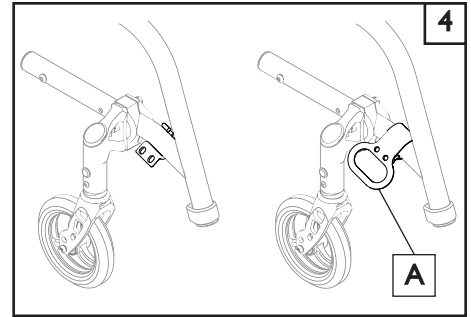
**3. Orientation of Transit Brackets for a Swing-away Setup**

6

- After loosely attaching the Transit loop to the lower front frame be sure to rotate the assembly to the outside of the chair.
- Rotate the Transit bracket loop to a 45° angle as shown in (figure 6) and hand tighten the screws(C).
- Using a 3/16" hex key, tighten and then torque the screws(C) to 120 in-lb.

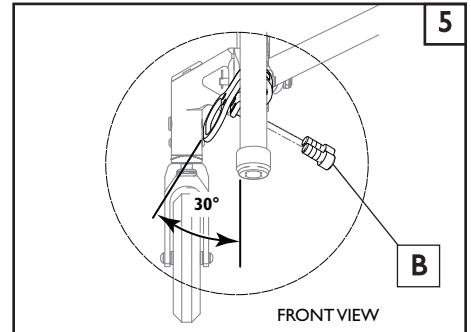
**C. CHECKOUT**

7

1. Double-check Orientation and Torque on all Hardware.

- Check that front and rear transit brackets have been installed evenly from side to side.
- Using a torque wrench and socket wrench with a 5/32", 7/16" and 5mm hex drive, check front and rear screws for correct torque.
- Place Transit stickers in the areas noted in Figure 7

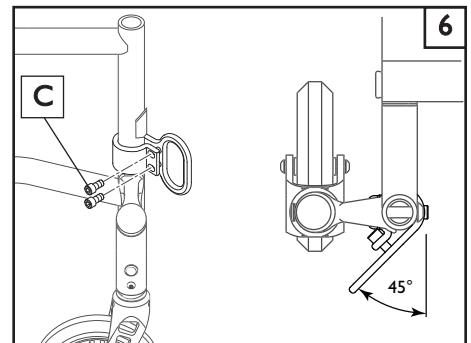
**DEALER/TECHNICIAN WARNING****⚠ WARNING**

Attention dealers and qualified technicians, do not operate or service this wheelchair without first reading the owners manual. If you do not understand the instructions and warnings in the owners manual please contact the Quickie Technical Service Department before operating and/or servicing the Quickie wheelchair. Failure to do so may result in damage and/or injury.

IMPORTANT– Please see the Q2 Lite owner's manual and WC-19 Transit supplement for additional warnings and information.

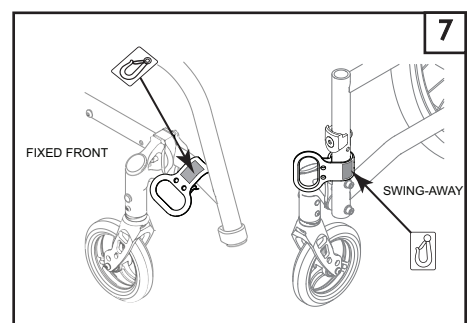

Sunrise Medical • 2842 Business Park Ave. • Fresno, CA 93727 • USA
In Canada (800) 263-3390