



Q2 TRANSIT INSTALLATION (WC-19)



Please read these instructions carefully before beginning the installation. Failure to understand and follow installation instructions may result in injury to installer and/or end user and may void the warranty. For more information on WC-19 Transit components, or if you have any questions, call Sunrise Medical Technical support at 800-333-4000 or go to www.sunrisemedical.com.

Parts included for Rear Transit:

- | | |
|-----------------------------------|--------------------------------|
| 1. 4x M8 1.25x14 BH (rear) | 6. 2x Rear Transit loop DAB |
| 2. 4x 1/4-28 BH Capscrew (rear) | 7. 2x Transit Frame Saddle Std |
| 3. 16x 1/4 flat washer (rear) | 8. 2x DAB Seat/Transit Bracket |
| 4. 8x 1/4-28 Nylock nut (rear) | 9. 2x Wave Washer |
| 5. 2x Rear Transit loop Std (L/R) | 10. 2x Pelvic belt Hardware |

Tools needed:

- 5mm hex key
- 5/32" hex key, 3/16" hex key
- 7/16" open end wrench
- Torque wrench and hex bits
- 21mm open end wrench

A. REAR TRANSIT BRACKET INSTALL

Works with serial numbers after: Q2V-091821, Q2H-009882.

1. Pre-installation: **I**

- Place your Q2 Wheelchair on a Table or Flat work surface for best installation results.
- Remove the wheels, armrests, and any other obstruction to gain access to the frame holes (A) that will secure the Rear Transit Bracket(J).
- In the case of the Q2 Depth Adjustable Back Model, or (DAB). Loosen and remove the 4 Screws (B) that hold the DAB Bracket (C) to the Backrest tube (D) with a 5/32" hex key and 7/16" wrench. You will need to remove and replace the outer bracket provided in your kit, and will re-use the inner DAB Bracket(E) as shown in Figure 3.

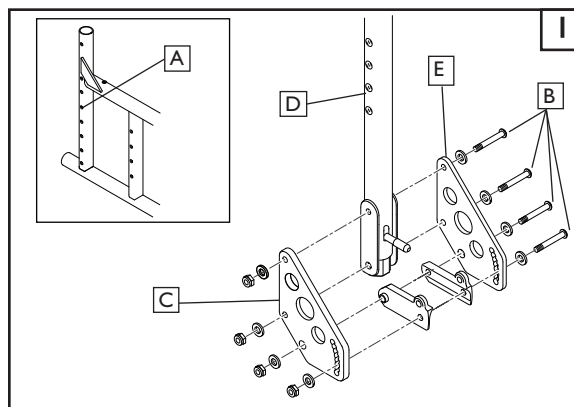

2. Install the Q2 Standard Rear Transit Brackets **2**

- Assemble the brackets and hardware for both sides of the chair as shown in figure 2.
- DO NOT use the hardware screw (G) unless you intend to install a WC-19 approved Lap Belt.
- Mount the Pelvic belt between Screw(G) and pivot (I). The washer and button head screw(H) include a patch that is intended to be permanent once installed.
- Apply the Transit notification stickers using the guide on page 2
- Torque all hardware to 144 in-lb.

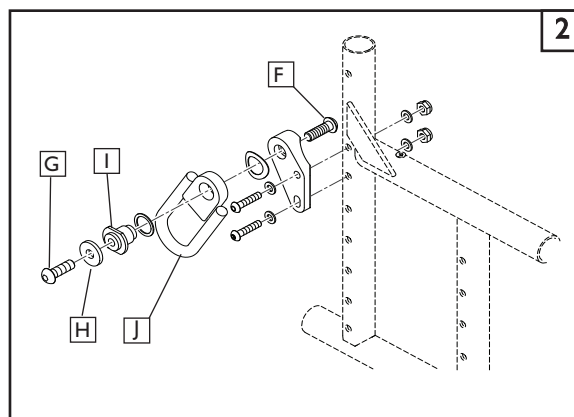

3. Install the Q2 Transit Brackets for a DAB configuration **3**

- Assemble the Brackets and hardware for both sides of the chair as shown in figure 3.
- Reinstall the new DAB Transit bracket (K) reversing the order of the instructions shown in Step 1.
- DO NOT use the hardware (G)(H) unless you intend to install a WC-19 approved Lap Belt.
- Mount the Pelvic belt between Screw(G) and pivot (I). The washer and button head screw(H) include a patch that is intended to be permanent once installed.
- Apply the Transit notification stickers using the guide on page 2
- Repeat this process for the other side of the wheelchair.

NOTE— Do not over-tighten the backrest plate pivot bolt as it may hinder the backrest from folding properly.

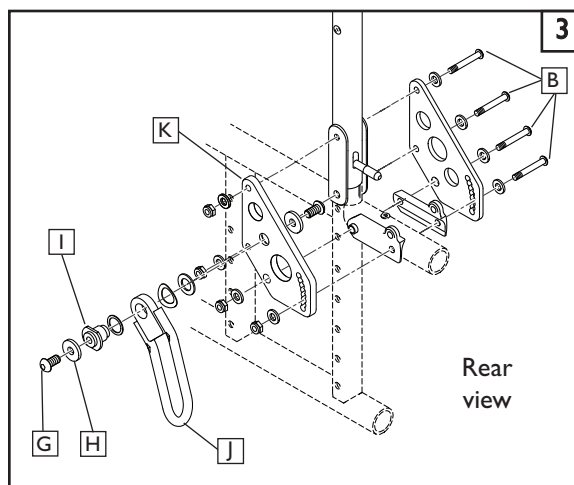

Parts included for Front Transit:

- | | |
|-----------------------------|-----------------------------|
| 1. 4x 1/4-28 SHCS (Front) | 5. 2x Transit Insert(Front) |
| 2. 2x 1" half saddle(Front) | 6. 4x 1/4-28 Automation nut |
| 3. 2x 1" saddle (Front) | 7. 4x 1/4AN washer |
| 4. 2x Front Transit Bracket | 8. 2x Transit Sticker |

B. FRONT TRANSIT BRACKET INSTALLATION**I. Assemble and Place the Front Transit Bracket**

4

- Assemble the brackets and hardware for both sides of the chair as shown in figure 4.
- For an easy installation, Start by sliding the Transit Insert(A) into the Front Caster Tube and hold in place by threading one of the screws thru both pieces. Assemble the Saddles, Washers, Transit hook (C), and caster barrel with eccentric washers and screws and attach the Nylock nuts to hold it all in place.

NOTE–Transit Insert (A) is required for Heavy Duty Transit Chairs.

- Finish by tightening the 1/4-28 socket head screws (B) to a maximum torque of 144 in-lb.
- Repeat this process for the other side of the wheelchair.

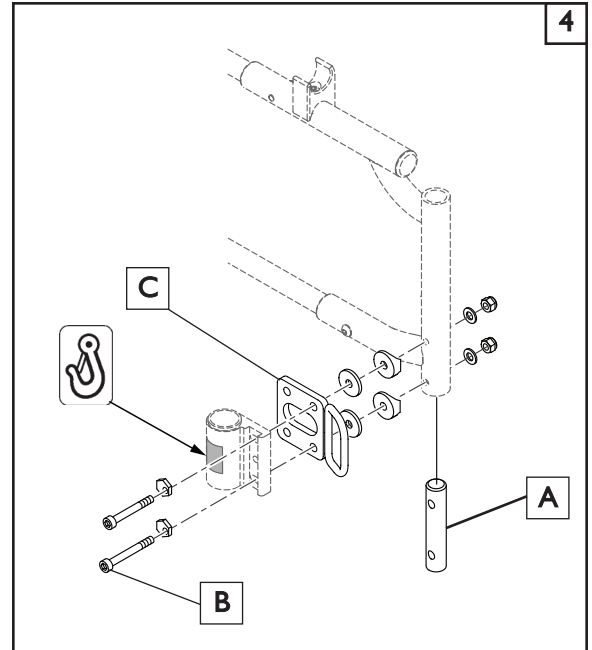
**C. CHECKOUT****I. Double-check Orientation and Torque on all Hardware.**

- Check that front and rear transit brackets have been installed evenly from side to side as shown in
- Using a torque wrench and socket wrench with a 3/16" and 7/32" hex drive, check front and rear screws for correct torque.
- Place Transit stickers in the areas noted in Figure 4

DEALER/TECHNICIAN WARNING**⚠ WARNING**

Attention dealers and qualified technicians, do not operate or service this wheelchair without first reading the owners manual. If you do not understand the instructions and warnings in the owners manual please contact the Quickie Technical Service Department before operating and/or servicing the Quickie wheelchair. Failure to do so may result in damage and/or injury.

IMPORTANT– Please see the Q2 owner's manual and WC-19 Transit supplement for additional warnings and information.

Sunrise Medical • 2842 Business Park Ave. • Fresno, CA 93727 • USA
In Canada (800) 263-3390