

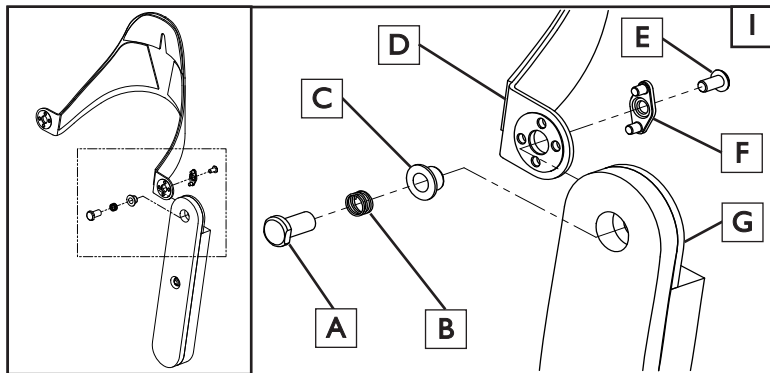

Please read these instructions carefully before beginning the installation. Failure to understand and follow installation instructions may result in injury to installer and/or end user and may void the warranty.

If you have any questions call Sunrise Medical Technical support at 800.333.4000



### Tools needed for installation

- 1x 1/8" hex wrench
- 1x 7/16" open end wrench
- 1x 3/8" diameter rod



### 1. Remove hardware, and remove parts 1 2

- a. Remove the cover.
- b. Using the 1/8" Hex wrench and 7/16" open-end wrench, remove the screw (E) shown in (Figure 1).

### 2. Remove the parts 1 3

- a. Remove the locking plate(F), release button(A) and spring(B).
- b. Using a 3/8" diameter rod, press out the flange bearing(C).
- c. Remove the swing-arm assembly(G).
- d. If necessary, repeat steps 1 and 2 for the other side.



### 3. Install parts 1 2 4

- a. Select correct assembly (Left or Right Hand) Look for the Letters "L" and "R" on the back of the arm.
- b. Verify that the Arm bend adjustment flexes out away from the head before installing the arm. Hex nut (H) may need to be loosened and/or tightened in order to maintain full support for the user.
- c. Align holes in the panel and Swing-away arm, and press in the flange bearing (C).
- d. Install locking plate(F), spring(B), and release button(A), and fasten with the button head screw(E).
- e. Using the 1/8" hex wrench, and 7/16" wrench, tighten the screw.

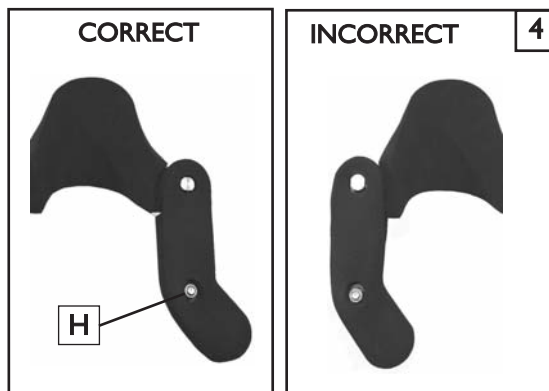

Sunrise Medical • 2842 Business Park Ave. • Fresno, CA 93727 • USA  
In Canada (800) 263-3390