



DECAL LOCATIONS/DEPTH ADJUSTMENT INSTRUCTIONS TILT & LIFT/TILT COMBO Q7ME



Please read these instructions carefully before beginning the installation. Failure to understand and follow installation instructions may result in injury to installer and/or end user and may void the warranty. If you have any questions call Sunrise Medical Technical support at 800-333-4000.

Parts required:

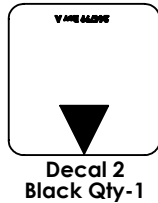
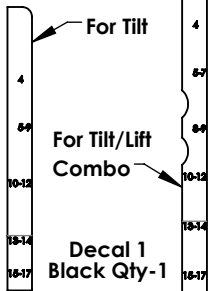

SEAT DEPTH ADJUSTMENT WARNING!
After adjusting the seat depth on the SEDEO ERGO rails to the desired position, make sure seat pan position matches the seat rail position by aligning the arrows

244800 Rev A

Decal 3 Yellow Qty-1

Tools required:

1. 5mm Hex key
2. Torque wrench

A. DECAL INSTALLATION

1. Attach decals in locations shown on right:
 - a. If changing from a Tilt to Lift/Tilt combo decals can be placed on top of any existing decals.



WARNING

Correct placement of decals is critical for correct seat depth alignment. Exception-decal 3.

Decal 1
Line-up top
and right
edges to
seat adapter

Decal 2
Line-up bottom
and right edges

Decal 3
Line-up
top edge

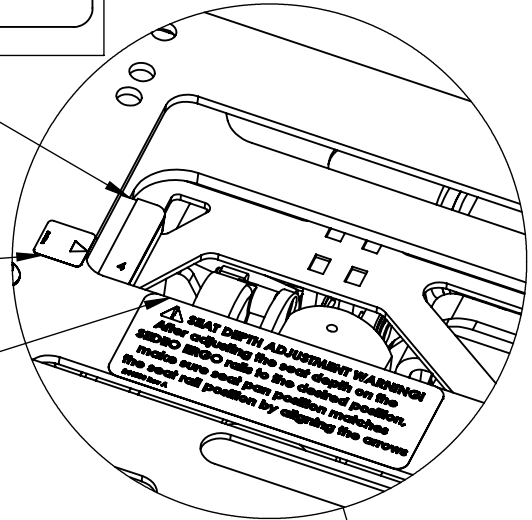

1a

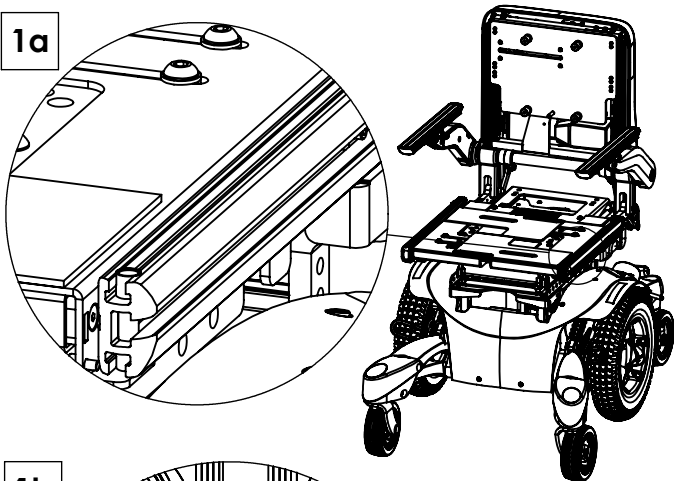

1

1b

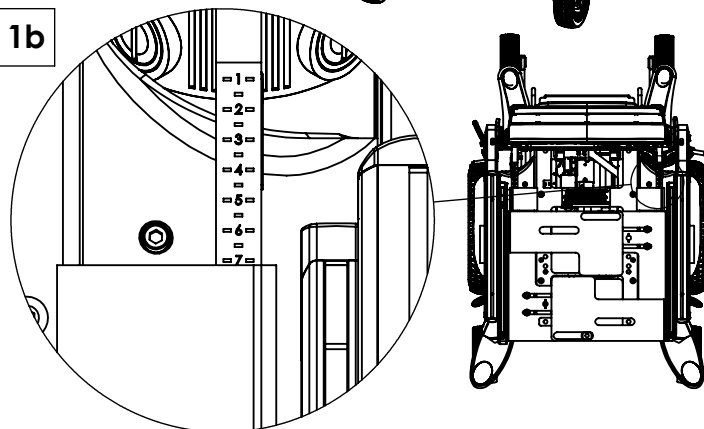

Top of seat

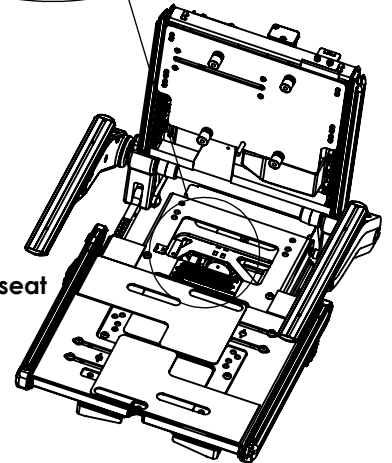

B. DEPTH ADJUSTMENT PREPARATION

1. Note current depth and determine which depth is desired.
2. For replacement of old adapter, make sure module to interface is at position C for tilt, position E for tilt/lift combo and request a new subset file. See page 2.

C. DEPTH ADJUSTMENT SEAT PAN 1

1. Using a 5mm hex key loosen the 4 bolts on the bottom sides of the seat. Figure 1a
2. Slide seat to desired depth. Depth is indicated on rail, Figure 1b.
3. Torque bolts to 10-11 ft-lbs (13.6-14.9Nm).



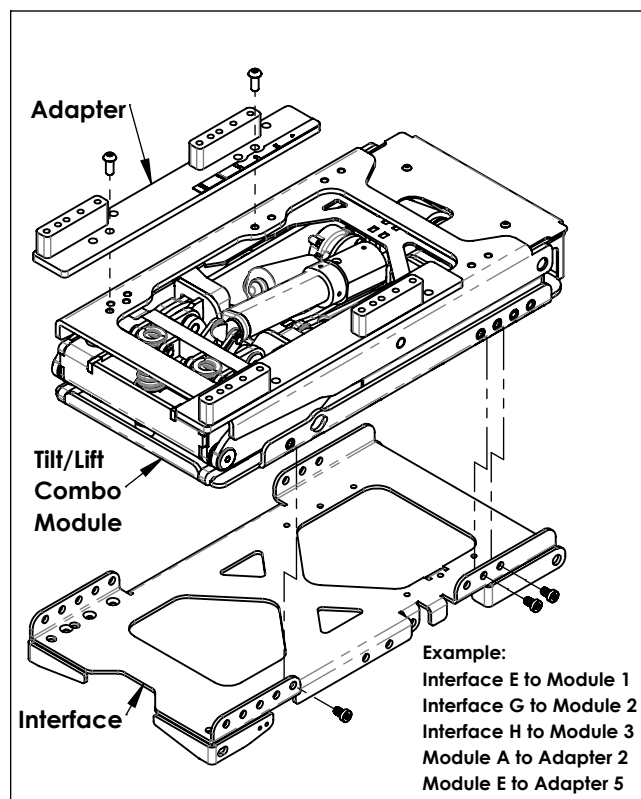
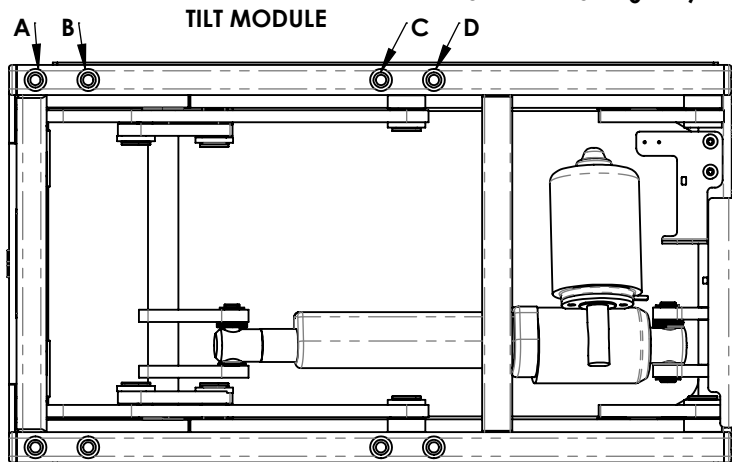
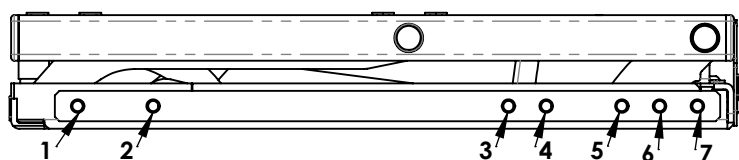
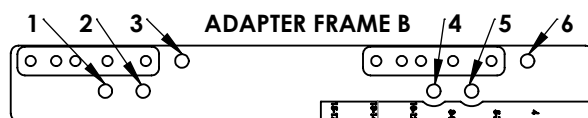
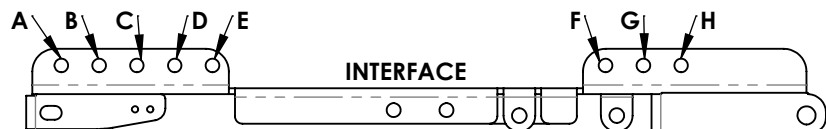

SEAT DEPTH	MODULE	INTERFACE to MODULE	MODULE to ADAPTER
SAME FOR ALL SEAT DEPTHS 17 - 22	TILT	Interface - Module C-1	Module - Adapter B-3
		F-4	D-6
		H-5	
	TILT/LIFT COMBO	Interface - Module E-1	Module - Adapter A-2
		G-2	E-5
		H-3	

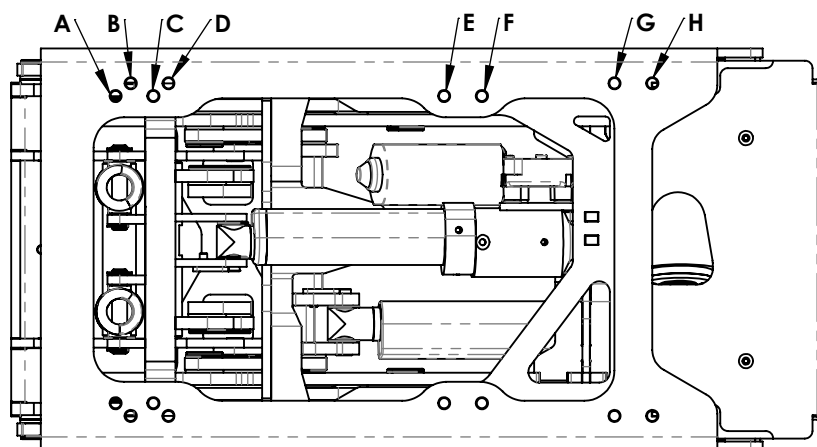
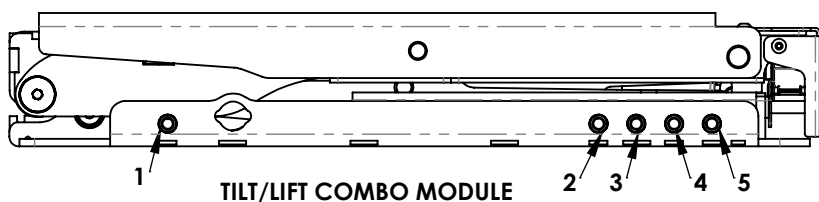

D. DEPTH ADJUSTMENT COMPONENTS 2

1. Note desired depth on chart, Figure 2.
2. Using the 5mm hex key remove the 4 bolts on the top of the seat pan and reposition to proper holes indicated on the chart.
3. Once front position is made the back holes will line up to the proper position.

E. DECAL ALIGNMENT 3

1. After adjustments are made ensure that the arrow on decal 2 lines up to the proper seat depth on corresponding decal 1, Fig 3 & 3a.



WARNING

Check decal and frame depth locations, Figure 3 & 3a. They should BOTH line up to the same seat depth position. If they do not make necessary adjustments and/or contact Sunrise Medical Technical Support 800-333-4000.

F. FINAL ADJUSTMENTS

1. Once all alignments are confirmed ensure that all bolts are torqued to 10-11 ft-lbs (13.6-14.9Nm).

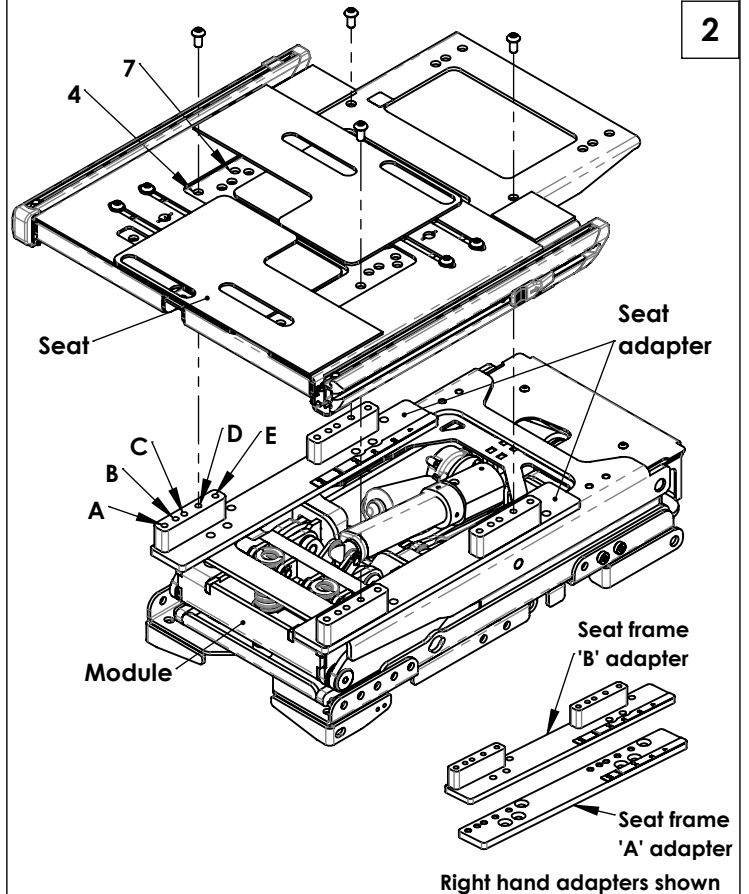

Right hand adapters shown

EXAMPLE:
For 18" seat depth with combo module and seat frame B: Seat position 7. Combo D-4 - 4 on the seat will line up to 'D' on the seat adapter.

Seat Depth	Seat Position	Tilt	Combo
17"	4	E-4	E-4
18"	7	D-4	D-4
19"	9	D-4	E-7
20"	12	E-7	D-7
21"	14	D-7	C-7
22"	17	C-7	A-7

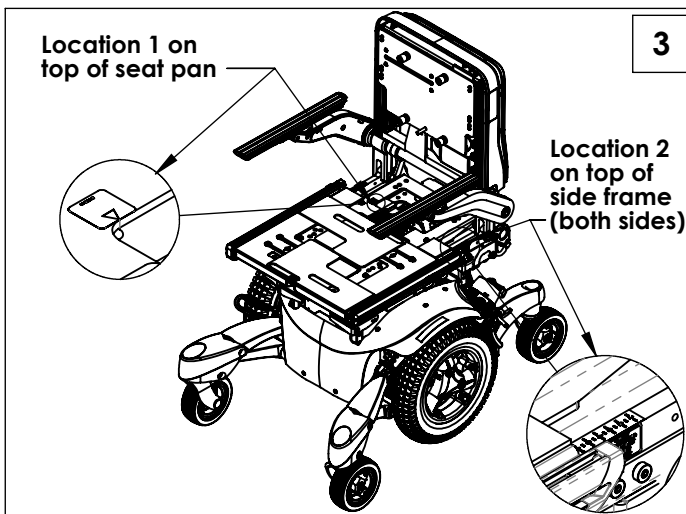

3a Example shown is for 18" seat depth with combo module and seat frame B.

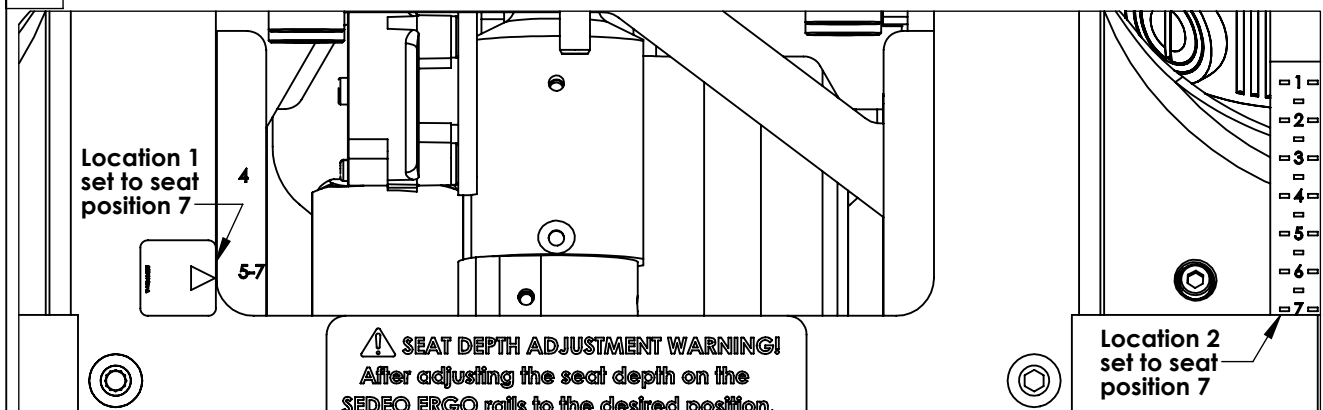

Sunrise Medical 2842 Business Park Ave Fresno, CA 93727 USA
In Canada (800) 263-3390